

ELECTRIC RPM MOTOR CONSOL 15 A

Instruction & assembly



1. Making sure the switch in the "OFF" position, connect the battery supply cable only to a 12 VDC power source
2. Install the consol in a safe location away from rain, chemicals or any other liquid or substance that may damage the circuit board.
3. Replace the fuse with same type and same amperage (if broken)
4. Temperature range is from -40 F to 131 F
5. Do not install the consol near a heat source
6. Do not open and attempt to repair the consol without the authorization of Salvarani Srl
7. Salvarani Srl is not responsible for malfunctioning of the consol due to a non authorized opening or due to a non proper installation of the consol.

Attention: Connect and disconnect the power supply cable only when the switch is in the "OFF" position. See picture.



COD. 905981 ELETRIC PRM MOTOR CONSOL 15 A

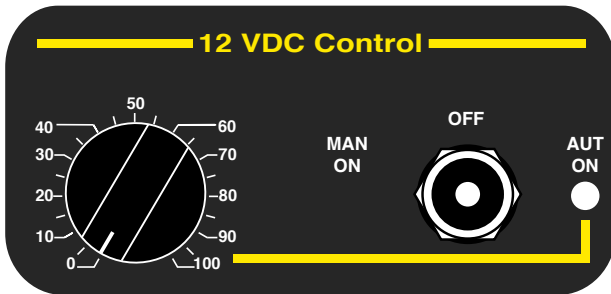

When the switch is on the "MAN" position, it will function at maximum RPM
When the switch is on the "AUT" position, you can use the knob to select the RPM speed from 0 (minimum) to 100 Maximum

N.B.: Maximun current is 15 amps

Wire harness connectors :

Pos	Color	Connectors
A	Black	Neg.motor
B	Red	Pos.motor

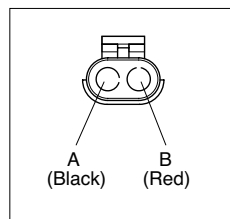

Connector

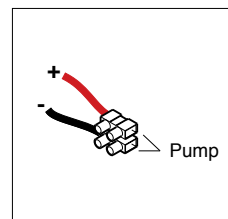

This device is complied with the European Directive 89/336/CEE- Electromagnetic Compatibility - and with the European Directive 73/23/CEE - Low Voltage.

ELECTRIC RPM MPTPR CONSOL 15 A

Instruction & assembly

905981-A

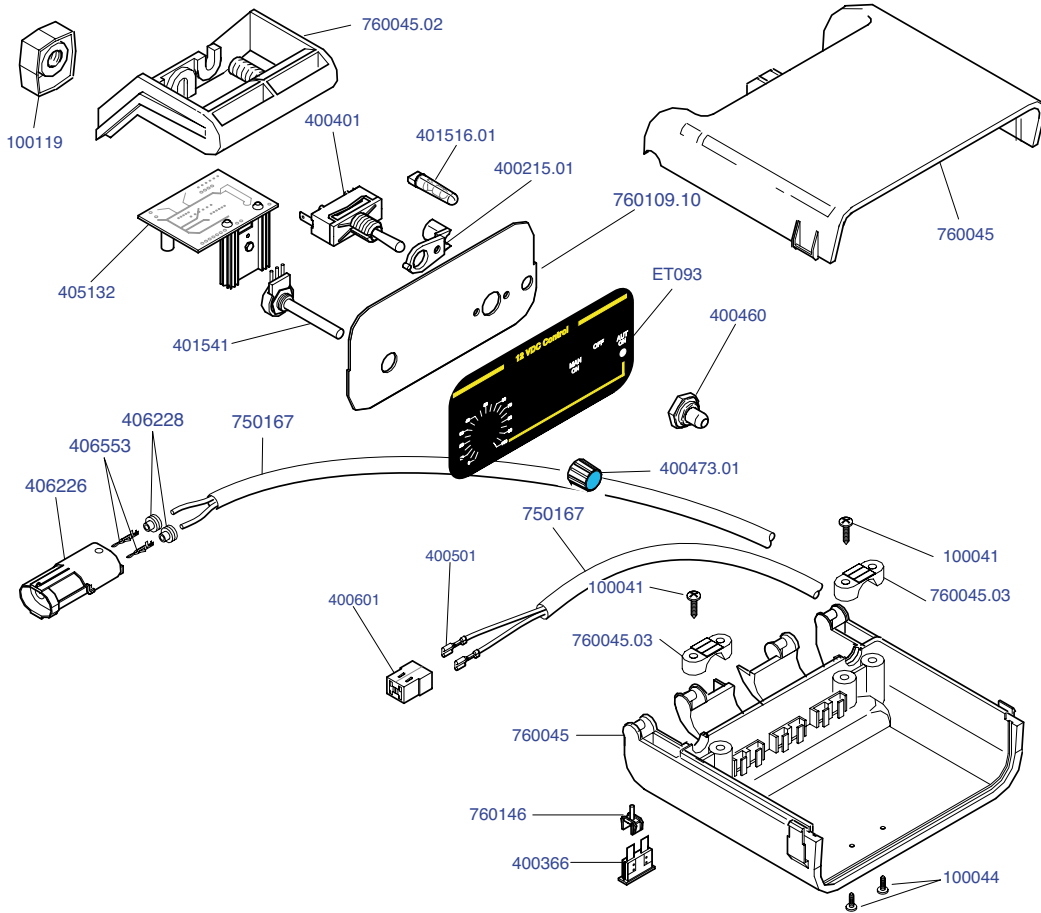

905981-B

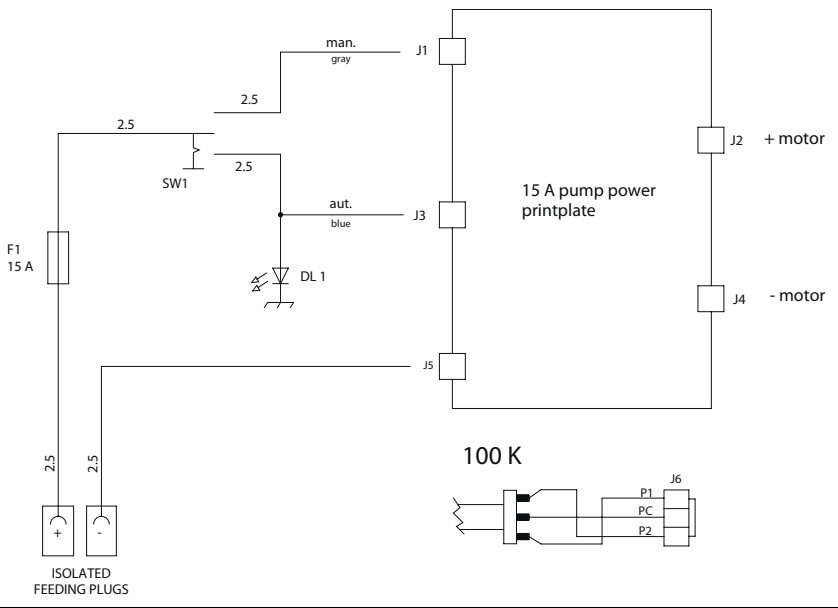
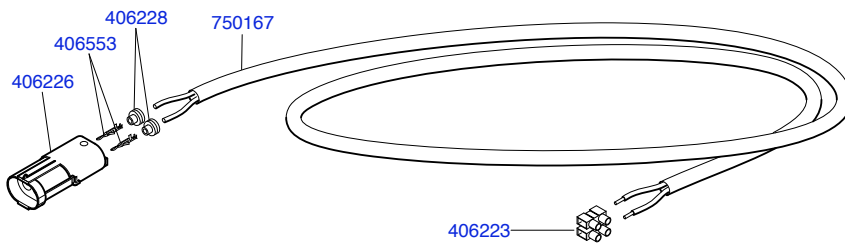

Salvarani North America
 6905 Jarry East
 Montreal, Quebec
 Canada
 H1P 1W7
 866-327-3880